

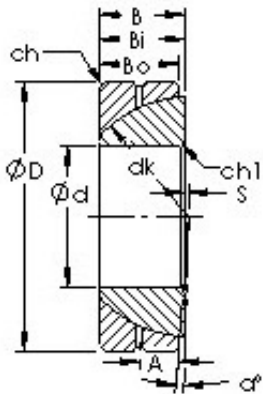

# ISB BEARING USA CO., LTD.



GAC45S Bearing 2D drawings and 3D CAD models

## AST GAC45S plain bearings

Bearing No. GAC45S

Size	45x75x20 mm
Bore Diameter	45 mm
Outer Diameter	75 mm
Width	20 mm
Bearing Type - steel-on-steel	steelonsteel
Bore Dia (d)	45.0000
Outer Dia (D)	75.0000
Width (B)	20.0000
Outer Width (Bo)	18.0000
Inner Width (Bi)	20.0000
Dynamic Load Rating (Cr)	108,000
Static Load Rating (Cor)	540,000
Max. shaft corner radius, or 45 deg. chamfer (ch1)	1.000
Max. housing corner radius, or 45 deg. chamfer (ch)	1.000
Spherical Diameter (dk or Dk)	68.500
Mis-alignment Angle (a deg.)	3
Lubrication Groove Location (A)	10.000
Spherical Center Location (S)	4
Weight (g)	416.00
Material	52100 Chrome steel, or equivalent